

# Monostar HL-130

KENMERKEN / FEATURES / MARKMALE

|            | HL-130 E12               | HL-130 E16               | HL-130 E18               |
|------------|--------------------------|--------------------------|--------------------------|
| H (max.)   | ± 12,70 m                | ± 12,70 m                | ± 12,80 m                |
| A (max.)   | ± 10,70 m                | ± 10,70 m                | ± 10,80 m                |
| C (min.)   | ± 1,72 m                 | ± 1,72 m                 | ± 1,83 m                 |
| DxF (min.) | 3,25 x 1,17 m            | 3,25 x 1,56 m            | 3,25 x 1,56 m            |
| ExF (max.) | 5,05 x 1,17 m            | 5,05 x 1,56 m            | 5,05 x 1,56 m            |
| H1         | 2,88 m                   | 2,88 m                   | 2,99 m                   |
| H2         | 2,80 m                   | 2,80 m                   | 2,91 m                   |
| H3         | 2,23 m                   | 2,23 m                   | 2,34 m                   |
| LxB        | 3,34 x 1,20 m            | 3,34 x 1,60 m            | 3,34 x 1,82 m            |
| G          | 2,49 m                   | 2,49 m                   | 2,49 m                   |
| M/N        | 200 / 183 mm             | 200 / 183 mm             | 255 / 317 mm             |
| ∅ D        | ± 3,12 m                 | ± 3,19 m                 | ± 3,19 m                 |
| (max.)     | 650 kg (2 pers. + 490kg) | 650 kg (2 pers. + 490kg) | 650 kg (2 pers. + 490kg) |
| (max.)     | 650 kg (2 pers. + 490kg) | 650 kg (2 pers. + 490kg) | 650 kg (2 pers. + 490kg) |
| (sec.)     | 44/43 sec.               | 44/43 sec.               | 44/43 sec.               |
|            | 3 km/h                   | 3 km/h                   | 2,8 km/h                 |
|            | 0,5 km/h                 | 0,5 km/h                 | 0,5 km/h                 |
|            | 21 x 8 x 15              | 21 x 8 x 15              | --                       |
|            | --                       | --                       | 26 x 12 - 12             |
| (max.)     | ± 25%                    | ± 25%                    | ± 25%                    |
|            | 250 Ah/k5/48 V           | 250 Ah/k5/48 V           | 250 Ah/k5/48 V           |
|            | 4.780 kg                 | 4.920 kg                 | 4.980 kg                 |

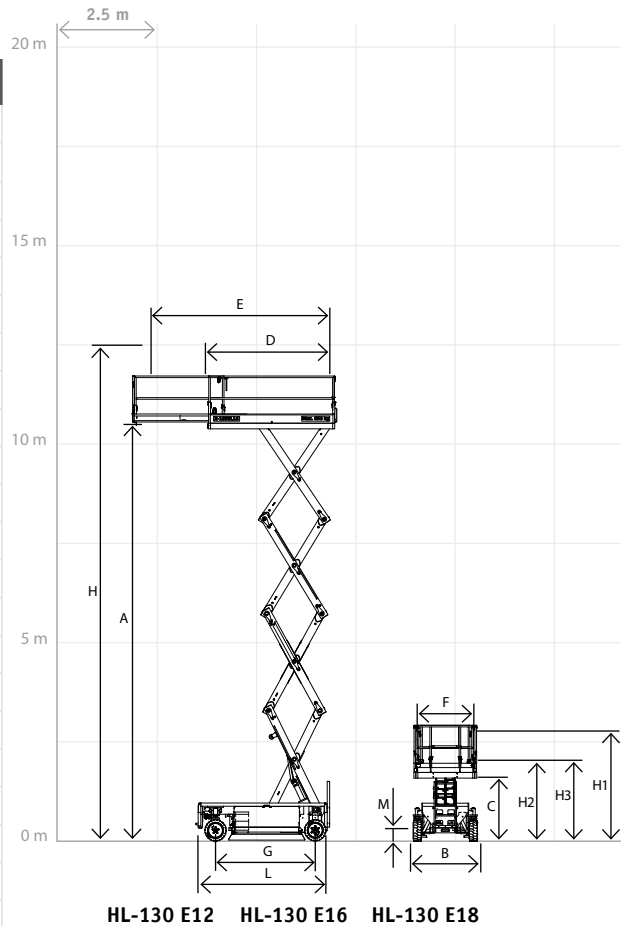

171214

© 2014, Holland Lift International B.V. All rights reserved. Designs and specifications may change without prior notice.

| NEDERLANDS                            | ENGLISH                                   | DEUTSCH                               |       |       |       |
|---------------------------------------|---|---------------------------------------|-------|-------|-------|
| <b>OPTIES</b>                         | <b>OPTIONS</b>                            | <b>OPTIONEN</b>                       |       |       |       |
| Besturing met snelsluitstekker        | Controlbox with quick disconnect          | Plattformsteuerung mit Schnellstecker | ●     | ●     | ●     |
| Urenteller                            | Hourmeter                                 | Stundenzähler                         | ●     | ●     | ●     |
| Lader (hoogfrequent)                  | Charger (high frequency)                  | Ladegerät (Hohfrequenz)               | ●     | ●     | ●     |
| 230V voorziening op platform          | 230V supply on platform                   | 230V Versorgung an der Plattform      | ○     | ○     | ○     |
| Rijden op volle hoogte                | Driving at full height                    | Fahren in voller Höhe                 | ●     | ●     | ●     |
| Rijden, proportioneel                 | Driving, proportional                     | Fahren, proportional                  | ●     | ●     | ●     |
| Sperfunctie                           | Differential lock                         | Differentialsperre                    | ○     | ○     | ○     |
| Vierwiel aandrijving (4WD)            | Fourwheel drive (4WD)                     | Allradantrieb (4WD)                   | --    | --    | --    |
| Smeersysteem (Easy Lube, Auto Lube)   | Lubrication system (Easy Lube, Auto Lube) | Schmiersystem (Easy Lube, Auto Lube)  | ○     | ○     | ○     |
| <b>VEILIGHEIDSVORZIENINGEN</b>        | <b>SAFETY FEATURES</b>                    | <b>SICHERHEITSEINRICHTUNGEN</b>       |       |       |       |
| Beschermhek                           | Scissor skirt                             | Schutzgitter                          | --    | --    | --    |
| Daalbeveiliging                       | Descent safety                            | Senkschutz                            | ●     | ●     | ●     |
| Flitslampen                           | Flashing beacons                          | Blinkleuchten                         | ●     | ●     | ●     |
| Rij-alarm (akoestisch)                | Drive alarm                               | Fahrwarnung (akustisch)               | ●     | ●     | ●     |
| Nooddaalvoorziening                   | Emergency descent                         | Notsenkvorrichtung                    | ●     | ●     | ●     |
| <b>TOEPASSING</b>                     | <b>APPLICATION</b>                        | <b>ANWENDUNG</b>                      |       |       |       |
| Voor gebruik in gesloten ruimten      | Indoors                                   | In geschlossenen Räumen               | ●     | ●     | ●     |
| Voor gebruik buiten                   | Outdoors                                  | Im Freien                             | --    | ●     | ●     |
| Toelaatbare min. omgevingstemperatuur | Certified min. temperature                | Zul. Tiefsttemperatur                 | -15°C | -15°C | -15°C |